

Olympus Twin Pack Quick Reference Guide

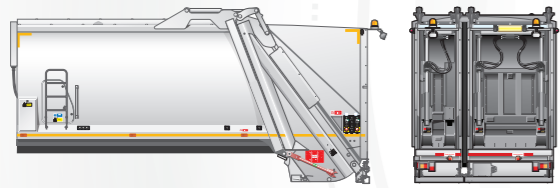

DENNIS EAGLE
RosRoca

Important

! This Quick Reference Guide is intended only as a reminder of the controls and their operation.

It is most important that before operating the refuse collection vehicle, all operatives:

- Have undertaken a recognised training course in the safe operation of the refuse collection vehicle.
- Read, understand and observe all the instructions, warnings and cautions stated in the Olympus Twin Pack Operator's Handbook.

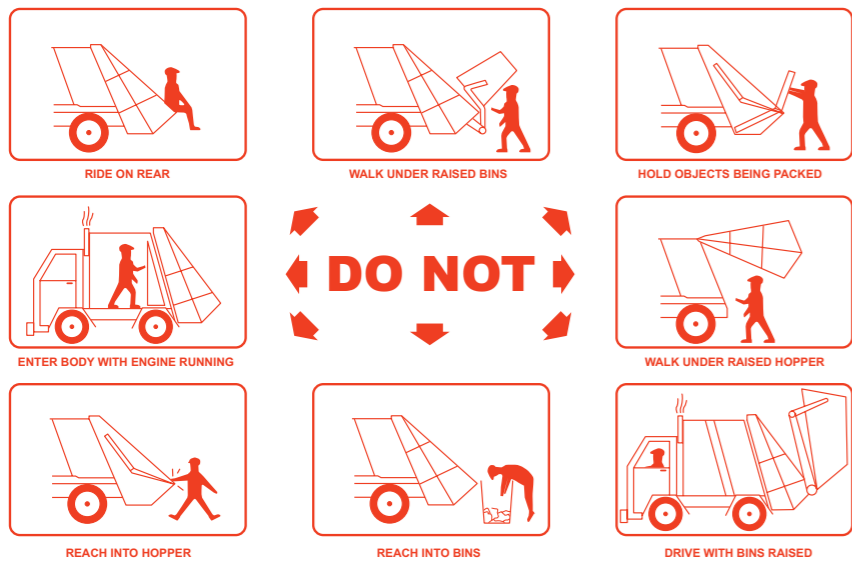

Loading Refuse

! **Caution:** Do not overfill the hopper when loading refuse.

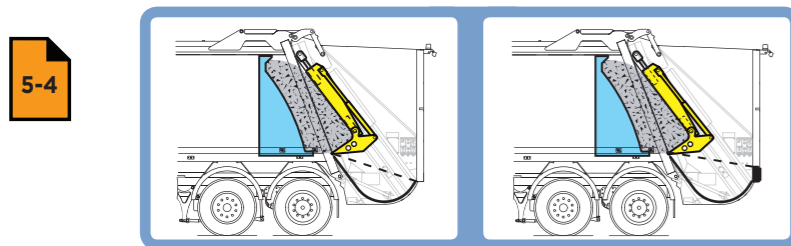

For detailed information, see relevant page in the
Olympus Twin Pack Operator's Handbook Service Manual

Energising the Control Panel

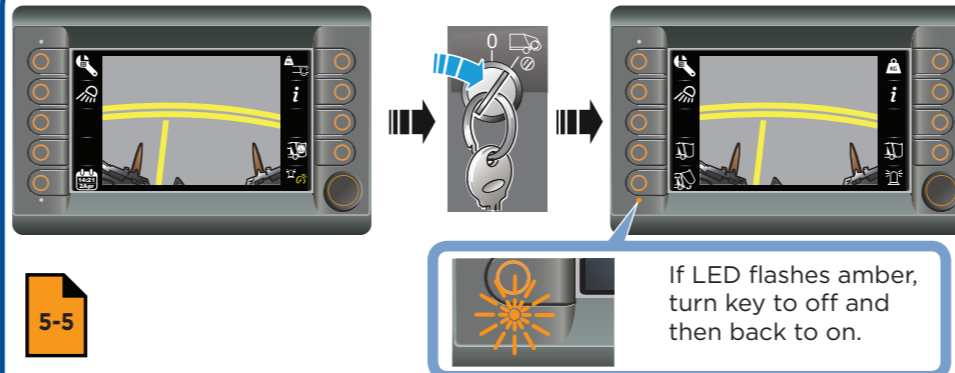

5-5

If LED flashes amber, turn key to off and then back to on.

To activate de-energised Start Pack Cycle push-button, press and release push-button.



5-6

Open System and Open Waste Container Lifting Device

5-8

1. Check that the tailgate area is clear.

2. Press and release the Start Pack Cycle push-button.

- The packer plate will open and stop.

3. Press and hold the Start Pack Cycle push-button.

- The carriage plate will move downwards and then stop.

4. Press and hold the Start Pack Cycle push-button. When packer plate starts to close, release the Start Pack Cycle push-button.

- The packer plate will continue to close and the carriage plate will move upwards automatically.

Closed Waste Container Lifting Device

1. Check that the tailgate area is clear.

2. Press and release the Start Pack Cycle push-button.

- The compaction mechanism will carry out one complete cycle and stop.

5-9

Discharging Refuse

! **WARNINGS:** MAKE SURE THAT YOU KNOW THE HEIGHT OF YOUR VEHICLE WITH THE TAILGATE AND LIFTING DEVICE, IF FITTED, RAISED.

ON 35/65 AND 40/60 BODIES ALWAYS DISCHARGE THE LEFT-HAND (SMALL) COMPARTMENT BEFORE DISCHARGING THE RIGHT-HAND (LARGE) COMPARTMENT.

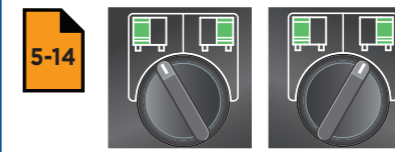

5-14

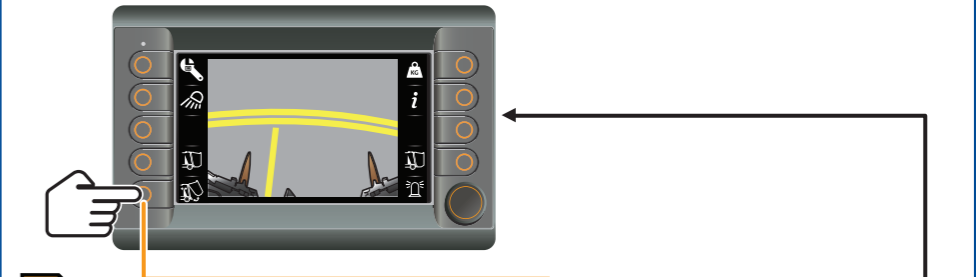

5-14

In-cab Controls

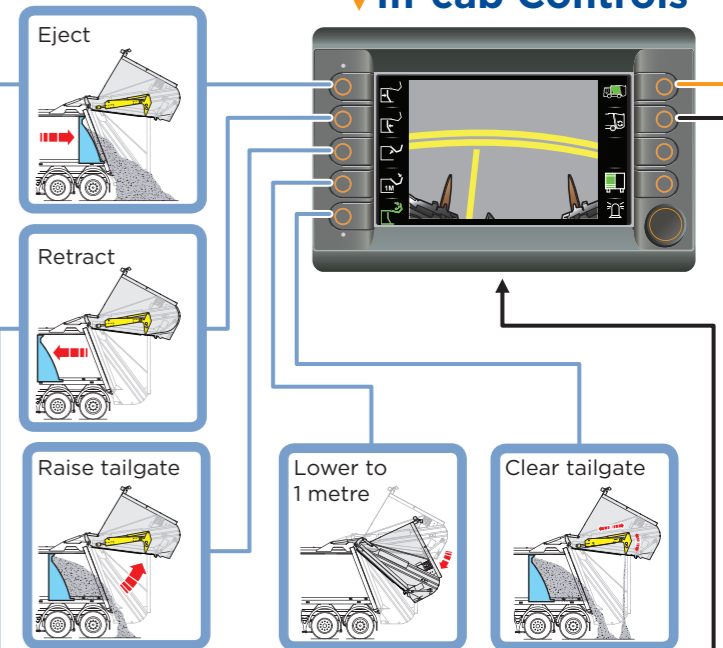

5-18

External Controls

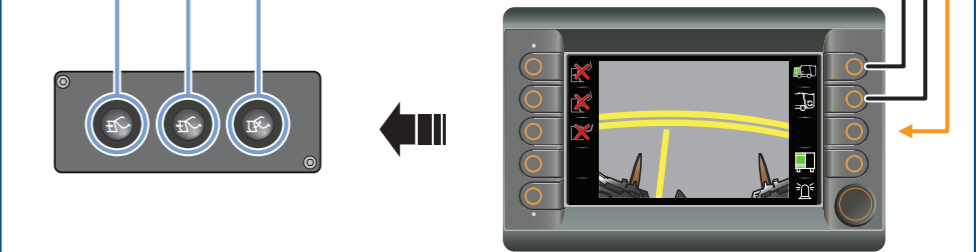

Lowering Tailgate

! **WARNING:** CHECK THAT THE TAILGATE AREA IS CLEAR.

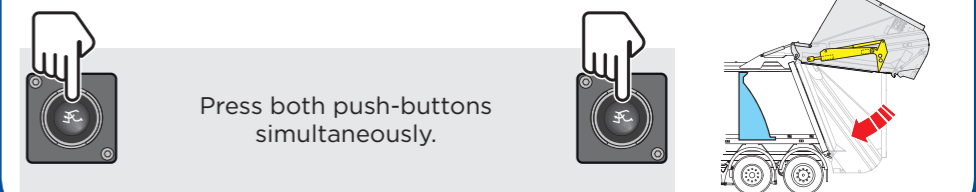

5-20

In An Emergency

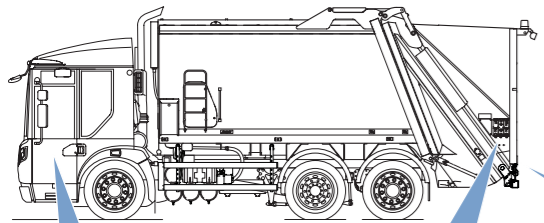

Press Any Red Emergency Stop Push-Button To Stop Machine Operating

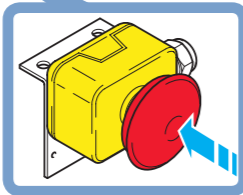
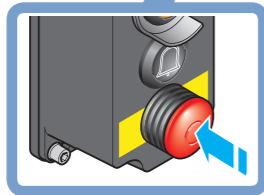

5-10

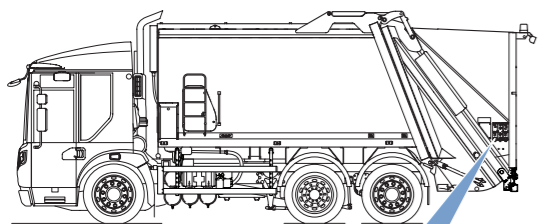

Press Yellow Push-Button To Rescue Compaction Mechanism

5-10

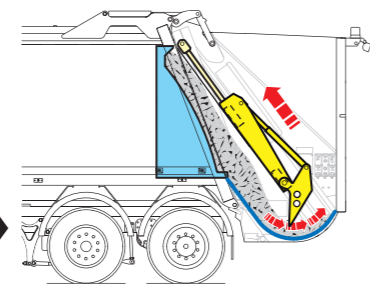

Warning Pictograms

4-15



	Tailgate out-of-locks/autobrake function.		Hydraulic oil filter blocked.		Footboard interlock override switch delay timer.
	Tailgate out-of-locks/autobrake override switch.		Hydraulic system overpressure.		Container overweight for weighing system.
	Rear view camera failed.		Tailgate out-of-locks.		Maximum body weight sensed by body weighing system.
	Green switch failed.		Flashing pictogram Tailgate out-of-locks switch fault.		Body weighing system switched 'off'.
	Tailgate signal button operated.		Tailgate raised.		Hydraulic oil level low.
	Emergency stop operated.		Body access door open.		Hydraulic oil over temperature cut out (Temperature > 90°C).
	Rescue function.		Waste container lifting device low.		Battery voltage low.
	Control systems communication error.		Footboard occupied.		System fault.
	Control systems communication error.		Footboard test switch operated.		
	Hydraulic oil hot (Temperature > 85°C).		Footboard interlock override switch operated.		

Lights

4-33

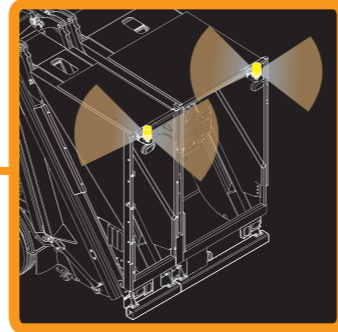

4-7

4-34

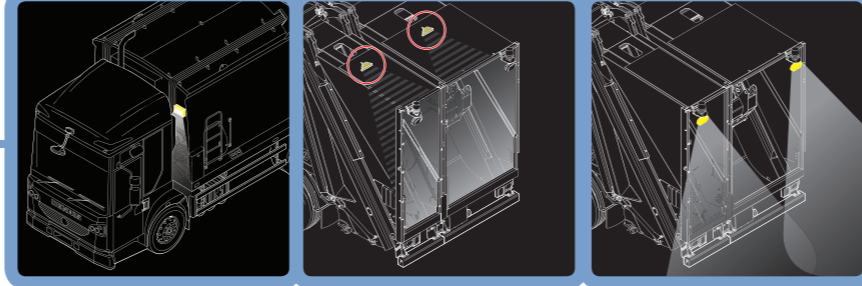

Weight - Multi-cycle

4-26



Compaction Rate

4-30



Brighten/Darken Screen

4-11



Maintenance

Drains

5-4

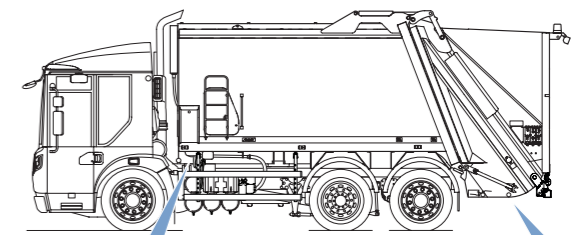

5-4

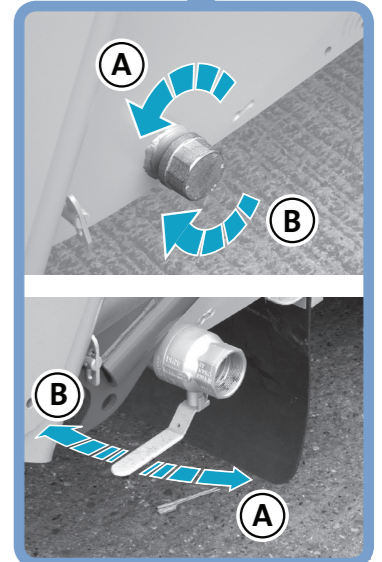
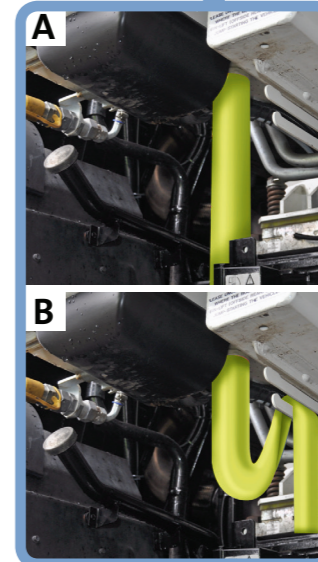

A = Open B = Close



WARNINGS:
HIGH PRESSURE WATER JETS CAN SERIOUSLY DAMAGE ELECTRICAL EQUIPMENT.
REMOVE REFUSE WHICH HAS ENTERED BODY IN FRONT OF EJECTION PLATE.
CLEAN UP ANY OIL SPILLAGE IMMEDIATELY.

Oil Level

4-3

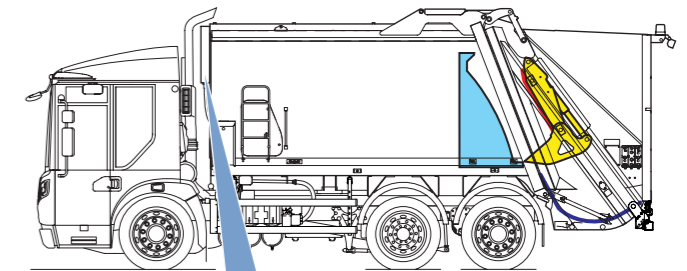

Oil level should be just below maximum level (A) when:

- Both tailgates fully lowered (cylinders open).
- Both ejection barriers fully extended to the rear of the body (cylinders open).
- Both compaction mechanisms in the normal start position.

