

Olympus Quick Reference Guide



DENNIS EAGLE
RosRoca

Important

! This Quick Reference Guide is intended only as a reminder of the controls and their operation.

It is most important that before operating the refuse collection vehicle, all operatives:

- Have undertaken a recognised training course in the safe operation of the refuse collection vehicle.
- Read, understand and observe all the instructions, warnings and cautions stated in the Olympus Operator's Handbook.

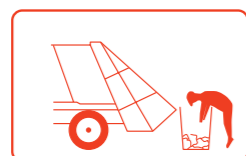
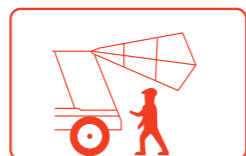
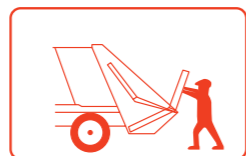

Loading Refuse

! **Caution:** Do not overfill the hopper when loading refuse.

5-4

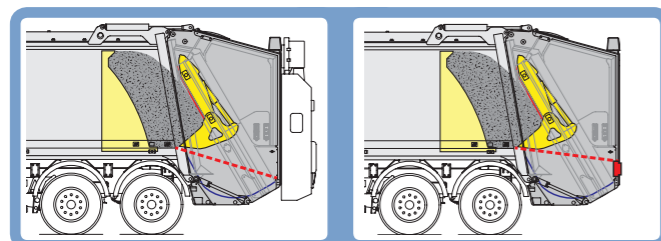

For detailed information, see relevant page in the;

Olympus Operator's Handbook Service Manual

Energising the Control Panel

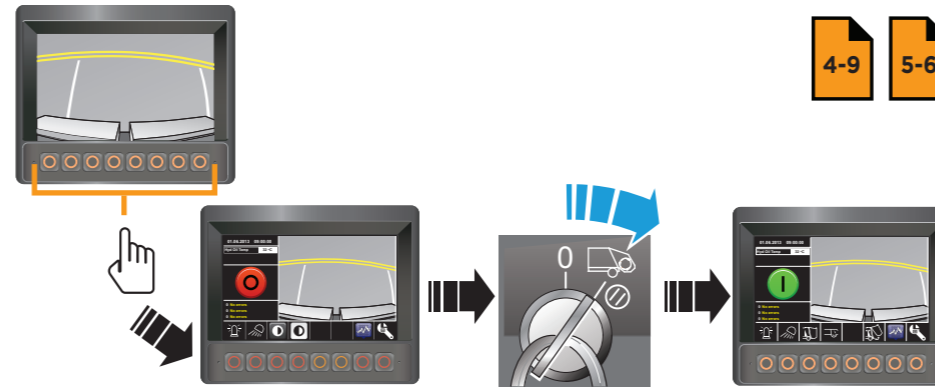

To activate de-energised 'Start pack cycle' push-button, press and release push-button.

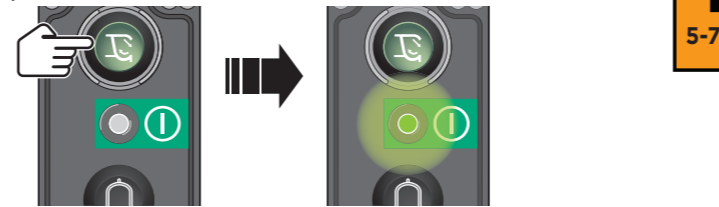

Open System and Open Waste Container Lifting Device

5-8

1. Check that the tailgate area is clear.

2. Press and release the 'Start pack cycle' push-button.

- The packer plate will open and stop.

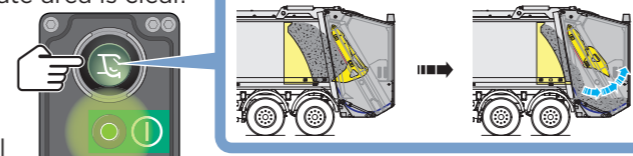

3. Press and hold the 'Start pack cycle' push-button.

- The carriage plate will move downwards and then stop.

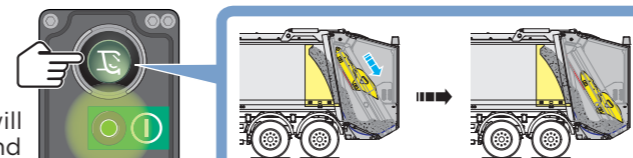

4. Press and hold the 'Start pack cycle' push-button. When packer plate starts to close, release the 'Start pack cycle' push-button.

- The packer plate will continue to close and the carriage plate will move upwards automatically.

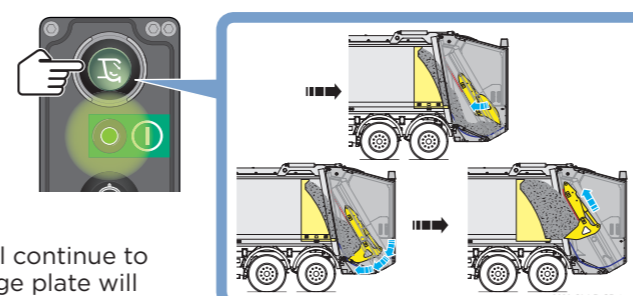

Closed Waste Container Lifting Device

1. Check that the tailgate area is clear.

2. Press and release the 'Start pack cycle' push-button.

- The compaction mechanism will carry out one or more complete cycles and stop.

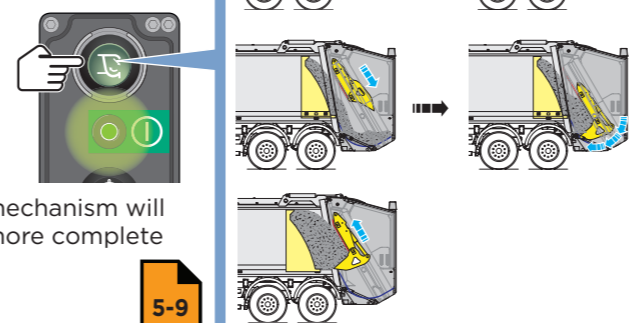

Discharging Refuse

! **WARNING:** MAKE SURE THAT YOU KNOW THE HEIGHT OF YOUR VEHICLE WITH THE TAILGATE AND WASTE CONTAINER LIFTING DEVICE, IF FITTED, RAISED.

Internal Controls

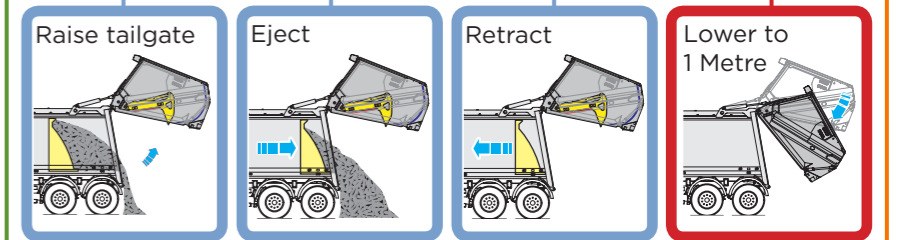
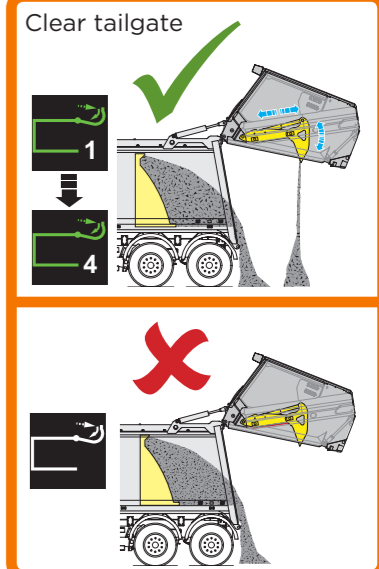
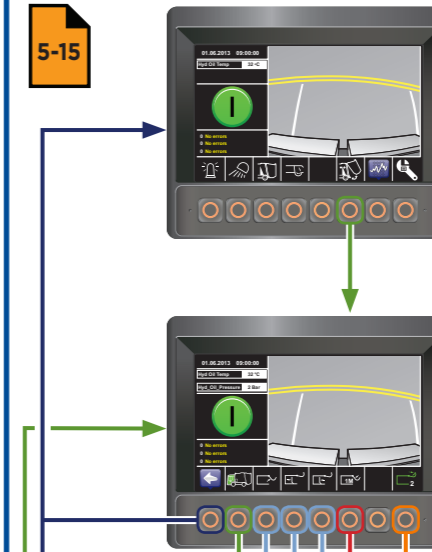

External Controls



Lowering Tailgate

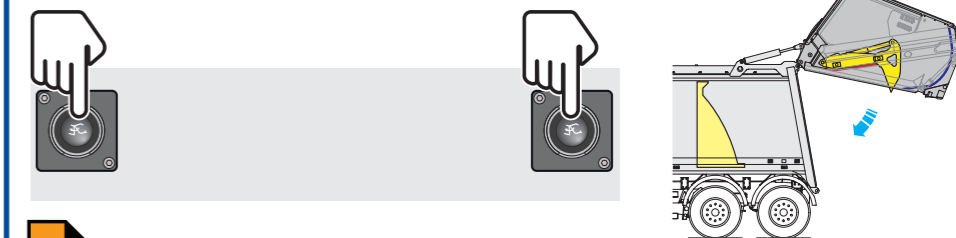

- 5-21
1. Check that the tailgate area is clear.
 2. Press both push-buttons simultaneously.

In An Emergency

Press Any Red Emergency Stop Push-Button To Stop Machine Operating

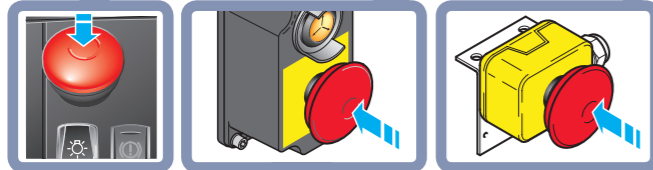
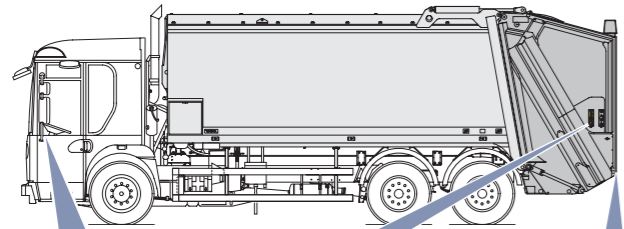

4-44

Press Yellow Push-Button To Rescue Compaction Mechanism

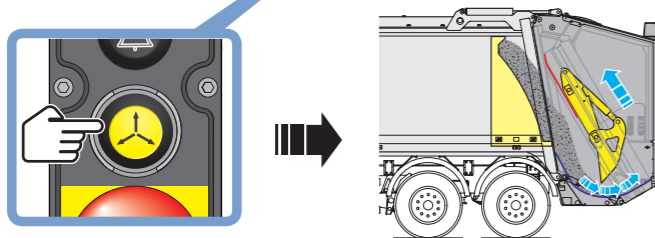
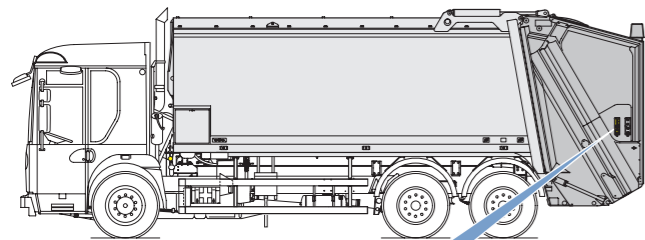

4-39

Warning Pictograms

4-12

	System off.		Hydraulic oil filter blocked.		Footboard test switch operated.
	System on.		Hydraulic system overpressure.		Overriding footboard safety device.
	Tailgate out-of-locks/autobrake function.		Control systems communication error.		Footboard interlock override switch operated.
	Tailgate out-of-locks/autobrake override switch.		Control systems communication error.		Footboard interlock override switch delay timer.
	Rear view camera failed.		System fault.		Waste container overweight for weighing system.
	Green switch failed.		Tailgate out-of-locks.		Hydraulic oil level low.
	Tailgate signal button operated.		Flashing pictogram. Tailgate out-of-locks switch fault.		Hydraulic oil over temperature cut out (Temperature > 90°C).
	Emergency stop operated.		Tailgate raised.		Battery voltage low.
	Rescue function.		Body access door open.		Footboard occupied.
	Body full.				
	Hydraulic oil hot (Temperature > 85°C).				

Warning Beacons

4-6

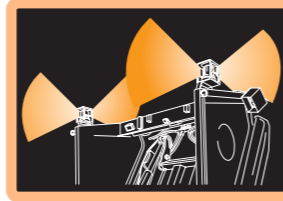

4-22



Lights

4-22

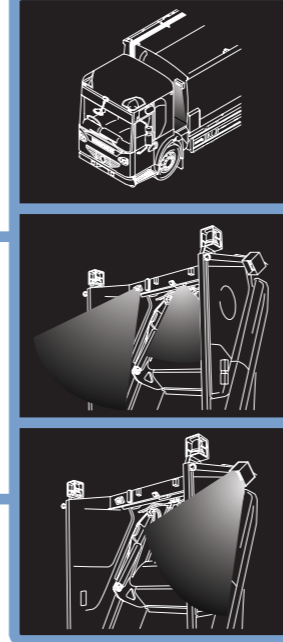

Brighten/Darken Screen

4-23



Compaction Rate

rest with organic
rest without organic
organic - garden
organic - restaurant
paper
paperboard
plastic
plastic - dsd
glass
not selected

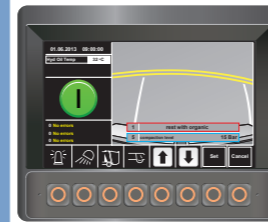

4-26

Multi-cycle

selected back
single
multi-cycle 2 cycles
multi-cycle 3 cycles
multi-cycle 4 cycles
multi-cycle 5 cycles
multi-cycle 6 cycles
multi-cycle 7 cycles
multi-cycle 8 cycles
multi-cycle 9 cycles
multi-cycle 10 cycles
continuous



4-28

Maintenance

Drains

5-4

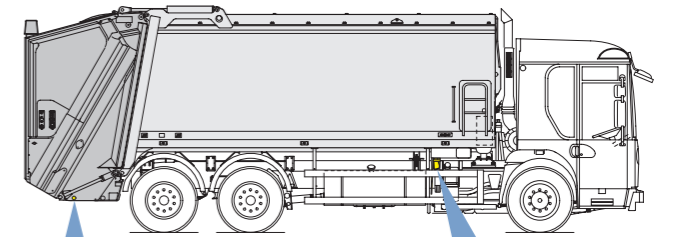

5-4

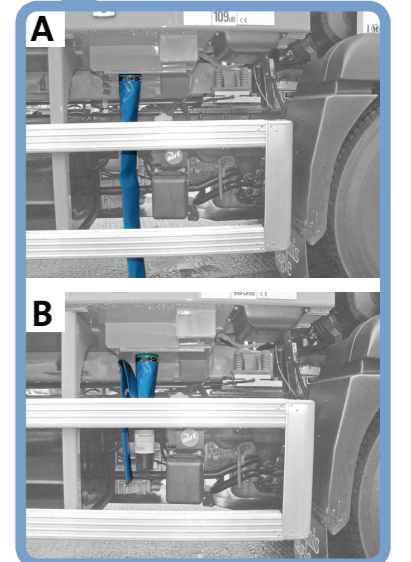
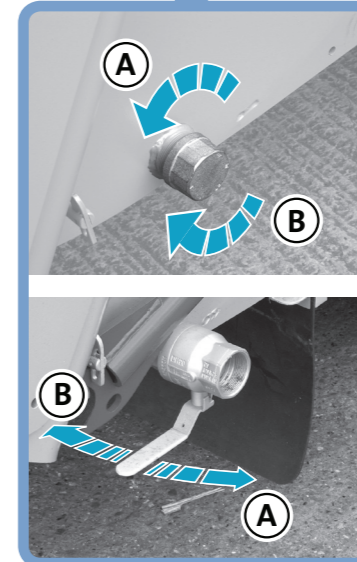

A = Open B = Close

WARNINGS:
HIGH PRESSURE WATER JETS CAN SERIOUSLY DAMAGE ELECTRICAL EQUIPMENT.
REMOVE REFUSE WHICH HAS ENTERED BODY IN FRONT OF EJECTION PLATE.
CLEAN UP ANY OIL SPILLAGE IMMEDIATELY.

Oil Level

4-3

